

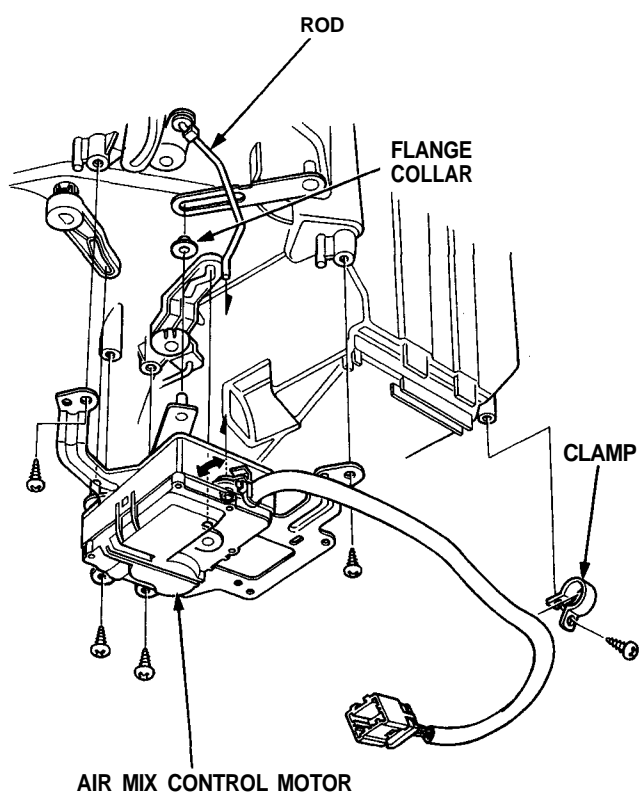

# Air Mix Control Motor

## Replacement

1. Remove the glove box lower panel and disconnect the connector from it (see page 21-54).
2. Disconnect the air mix control motor connector.
3. Remove the air mix control motor as shown.



4. Install the air mix control motor in the reverse order of removal. After installation, make sure the air mix control motor operates smoothly.

## Test

1. Connect battery power to the No. 1 terminal of the air mix control motor, and connect ground to the No. 2 terminal; the air mix control motor should run, and stop at COOL.  
If it doesn't, reverse the connections; the air mix control motor should run, and stop at HOT.

NOTE: If the air mix control motor does not run, remove it, and check the air mix control linkage and doors for smooth movement. If the air mix control linkage and doors move smoothly, replace the air mix control motor.

2. Measure resistance between the No. 3 terminal and No. 5 terminal, it should be approx. 6 k $\Omega$ .
3. Measure resistance between the No. 5 terminal and No. 6 terminal, it should be approx. 1.2k $\Omega$  at HOT and approx. 4.8 k $\Omega$  at COOL.

